



# RoomMatch<sup>®</sup> Utility

Small-Format Foreground/Fill Loudspeakers

Installation and Safety Guidelines  
Instrucciones de instalación y de seguridad  
Installation et instructions de sécurité  
Installations- und Sicherheitshinweise

**This product is intended for installation by professional installers only!** This document is intended to provide professional installers with basic installation and safety guidelines for Bose RoomMatch® Utility loudspeakers in typical fixed-installation systems. Please read this document before attempting installation.

**WARNING:** All Bose® products must be used in accordance with local, state, federal and industry regulations. It is the installer's responsibility to ensure installation of the loudspeakers and mounting system is performed in accordance with all applicable codes, including local building codes and regulations. Consult the local authority having jurisdiction before installing this product.

**WARNING:** Unsafe mounting or overhead suspension of any heavy load can result in serious injury and equipment damage. It is the responsibility of the installer to evaluate the reliability of any mounting method used for their application. Only professional installers with the knowledge of proper hardware and safe mounting techniques should attempt to install any loudspeaker overhead.

### Guidelines for Permanent Installation of RoomMatch Utility Loudspeakers

The installation information contained in this document is only a general guideline and cannot, as such, represent all requirements and precautions. Accordingly, anyone using this material assumes all liability and is expressly responsible for the safety of all loudspeaker array designs and mounting configurations applied in practice.

1. Prior to the installation of any overhead loudspeaker, a licensed professional engineer must approve the location and method of attachment to the building structure and confirm they are consistent with all building codes and regulations. Ensure the mounting surface and the method of attaching the loudspeaker system to the surface is capable of supporting the total weight of the system. A safety factor of 10:1 is recommended.
2. Obtain all mounting system components from reputable manufacturers. Select a mounting system appropriate for your loudspeaker system and its intended application. We recommend Bose mounting accessories when available. A licensed professional engineer must review the design and fabrication of any custom mounting hardware.
3. Bose RoomMatch Utility loudspeakers feature integrated M8 threaded inserts to facilitate loudspeaker mounting by professional installers. Do NOT use SAE 5/16" size threaded hardware! Use only metric hardware. Fasteners should be metric Class 8.8 (load bearing rated) or equivalent. Unmarked (not rated for load bearing) fasteners should not be used.
4. Use lock washers or a locking compound intended for hand disassembly, such as LOCTITE® THREADLOCKER BLUE 242® compound, for a vibration resistant assembly.
5. Fasteners should be tightened using torque of 15 to 20 foot-pounds (21 to 28 Newton-meters). Over-tightening the fasteners could result in irreparable damage to the cabinet and create an unsafe assembly.
6. Do not attempt to alter the threaded attachment points or re-thread the attachment points to accommodate any other thread size or type; doing so will compromise the safety while permanently damaging the loudspeaker.
7. Use a safety cable, separately attached to the cabinet, at a point not in common with the load bearing attachment points of the mounting system to the loudspeaker. This is recommended even if not required by local regulation. Consult a licensed professional engineer or a rigging professional for proper design and installation.

**CAUTION:** Installed loudspeakers require regular inspection and routine maintenance to ensure proper function and safe operation. Inspect mounting hardware and attachments for signs of corrosion, bending or any other condition that may decrease the structural integrity. Immediately replace worn or damaged components.

**CAUTION:** Make no modifications to the loudspeakers or mounting accessories. Unauthorized alterations may compromise safety and could result in damage, injury, or death.

**CAUTION:** Never exceed 1 RoomMatch Utility loudspeaker using the included U-bracket. Additionally, never exceed 1 RoomMatch Utility loudspeaker using the rear-enclosure M8 threaded inserts to attach to any supporting surface.

**CAUTION:** This product must be used indoors.

## Product Overview

RoomMatch® Utility (RMU) small-format loudspeakers are intended for use in high-quality foreground music, under-balcony, zone fill, and vocal-range floor monitor applications. The design features a single Bose® EMB2 compression driver to provide mid/high frequency voicing similar to that of RoomMatch full-range array modules.

### Common Features

- U-bracket is included for surface-mount installations
- Rear-panel threaded inserts can accept optional pan-and-tilt brackets
- Standard connector panel can be replaced with an optional 40-watt or 100-watt 70V/100V transformer kit

Figure 1. RoomMatch Utility loudspeakers with included U-Bracket

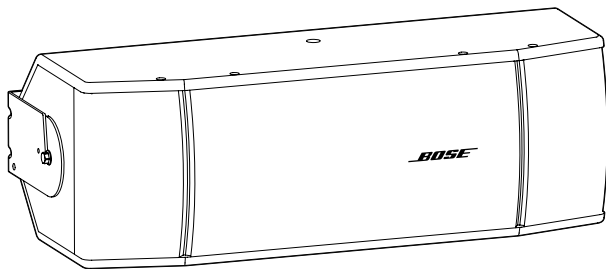

RMU208

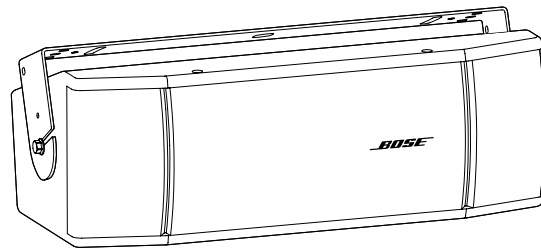

RMU206

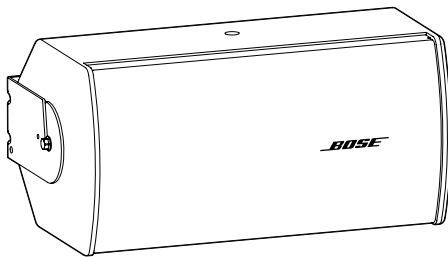

RMU108

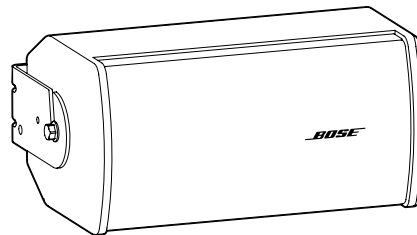

RMU105

### Parts List

Each RoomMatch Utility loudspeaker carton includes the following parts:

- RoomMatch Utility Loudspeaker
- U-bracket
- Hardware kit with M8 pan head bolts and rubber washers
- T3 square drive
- Installation guide

Please complete and retain for your records. Serial and model numbers are located on the rear panel of the loudspeakers.

Serial number: \_\_\_\_\_

Model number: \_\_\_\_\_

### Loudspeaker and U-Bracket Dimensions

Figure 2. RMU208 loudspeaker and U-bracket dimensions

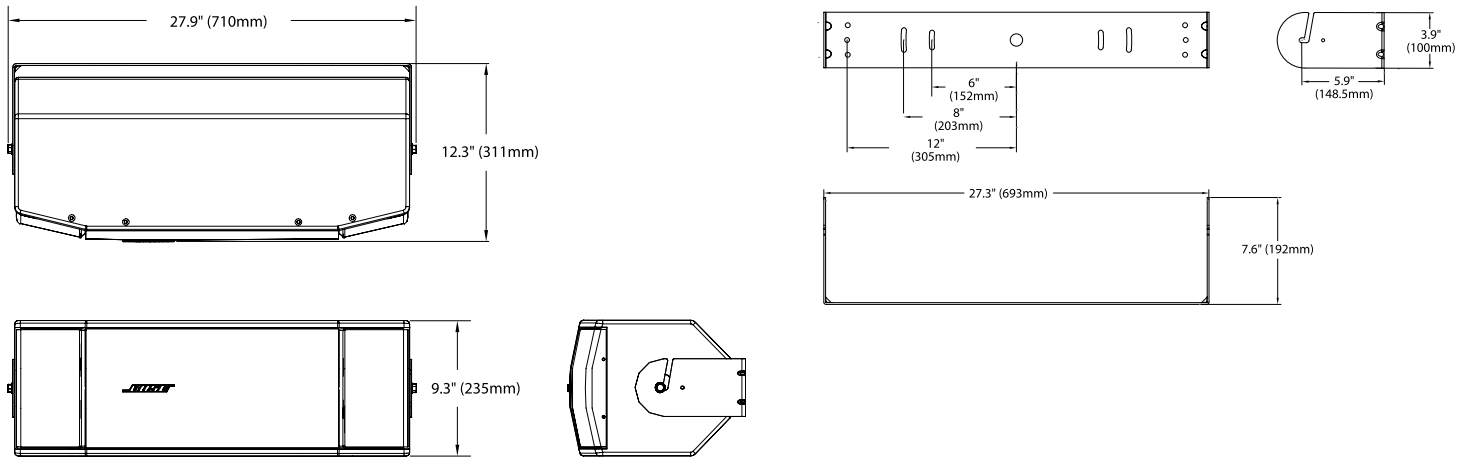

Figure 3. RMU206 loudspeaker and U-bracket dimensions

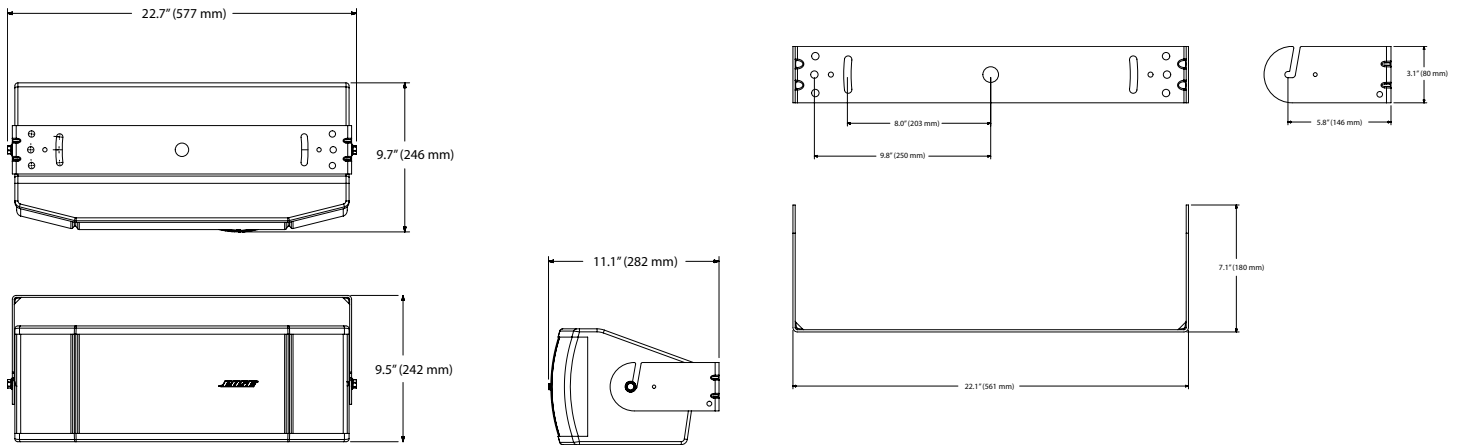

Figure 4. RMU108 loudspeaker and U-bracket dimensions

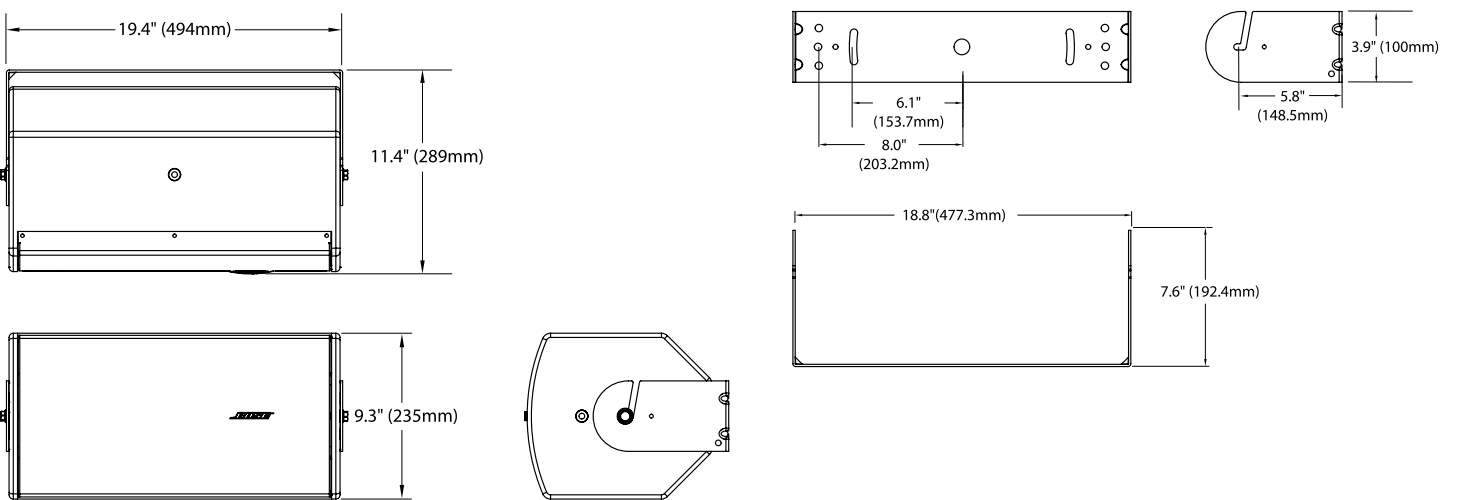
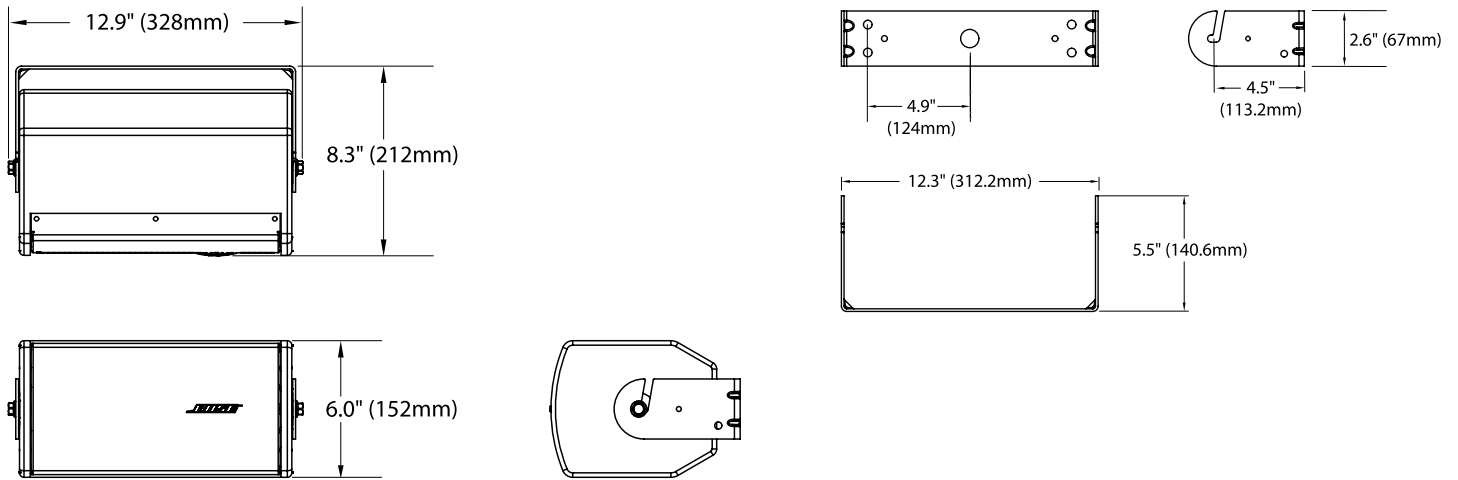

Figure 5. RMU105 loudspeaker and U-bracket dimensions



**Connector Panel**

The connector panel is identical for all models and includes dual NL4 connectors, to allow “loop through” connections, and a screw-terminal barrier strip.

Figure 6. RMU speaker input connectors

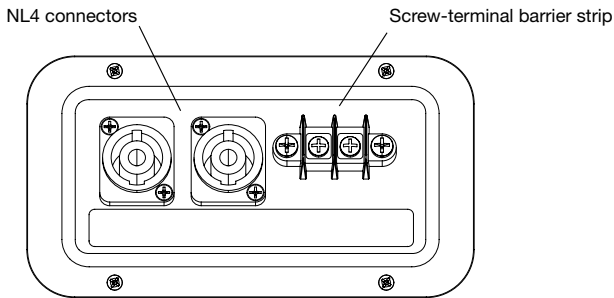

**Speaker Pitch Angles**

The maximum pitch angles for RMU loudspeakers when horizontally mounted with the included U-bracket are as follows.

	Wall Mounted	Ceiling Mounted
RMU208	-110°	-110°
RMU206	-110°	-110°
RMU108	-110°	-110°
RMU105	-110°	-110°

## Mounting RMU Loudspeakers with U-Bracket

### Before You Begin – Recommended Tools

- 10 mm sockets and socket wrenches – for M8 bolts on U-bracket
- T3 square drive (included) – for removing plastic inserts

**CAUTION:** The RMU loudspeakers can weigh up to 43 lbs (19.5 kg) with U-brackets attached. Use caution when lifting to avoid injury and/or damage to the speaker. Refer to the following table for specific weights of each model.

Table 1: Weights of RMU Loudspeakers				
	RMU208	RMU206	RMU108	RMU105
Net Weight	37 lbs (16.8 kg)	25 lbs (11.3 kg)	21 lbs (9.5 kg)	12 lbs (5.4 kg)
Net Weight with U-Bracket	43 lbs (19.5 kg)	30 lbs (13.6 kg)	26 lbs (11.8 kg)	15 lbs (6.8 kg)

**CAUTION:** Do not place loudspeakers resting on their grilles.

### To install the RMU loudspeakers with the included U-bracket:

1. Choose a mounting location that will safely support the weight of the loudspeaker.
2. Remove packing materials and place the loudspeaker on the floor beneath the planned suspension point.
3. Using the included T3 square drive, remove the plastic insert on each end of the loudspeaker.
 

**CAUTION:** Do not attach the loudspeaker to the U-bracket using the plastic inserts.
4. Insert one M8 bolt and rubber washer into the threaded hole on each end of the loudspeaker. Do not tighten.
5. Hold the U-bracket in the mounting location and mark the holes.
 

**CAUTION:** For attaching U-brackets to the surface, choose fasteners that are consistent with all local building codes and requirements to support the weight of the speaker (refer to “Table 1: Weights of RMU Loudspeakers”). As a general guideline, use 5/16” x 3” lag screws into wood and 5/16”-18 double expansion anchors into concrete and masonry block.
6. Drill holes into mounting surface using previously marked positions.
7. Attach the U-bracket to the building surface using the required fasteners specified in Step 3.
8. Hang the loudspeaker on the bracket by lowering the M8 bolts into the bracket slots keeping the rubber washers between the bracket and the speaker enclosure. See Figure 8.

Figure 7. Installing the speaker on the U-bracket

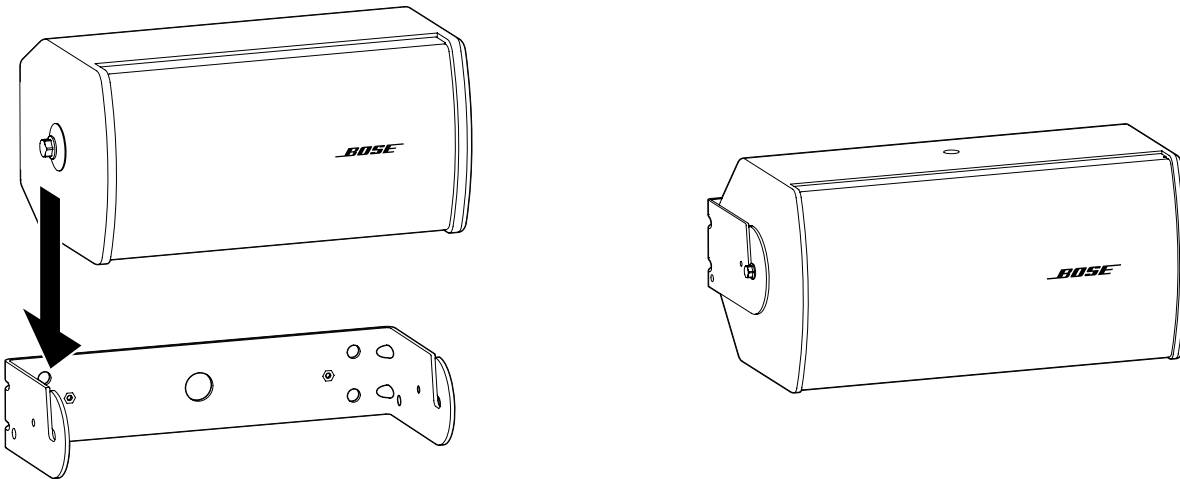

9. Position the loudspeaker in the desired pitch angle.
10. Tighten the 2 bolts with a 10 mm socket tool using a torque not to exceed 15 to 20 foot-pounds (21 to 28 Newton-meters).
 

**Note:** Optionally, for more secure mounting of pitch angles, a wood screw may be inserted into the small hole in the side of the U-bracket and tightened into the wood enclosure.
11. Connect field wiring and test loudspeaker operation.

## Rotating the High-Frequency Waveguides

The high-frequency waveguide in the RMU208, RMU206, and RMU108 loudspeakers can be rotated to provide the desired coverage pattern for horizontal or vertical speaker mounting. These speakers are assembled in the factory for horizontal mounting. To rotate the waveguide for vertical mounting, do the following.

1. Remove the 12 screws from around the speaker grille and remove the grille from the enclosure.
2. Remove the 4 waveguide screws.
3. Pull the waveguide forward, rotate it 90° and place it back into the enclosure.
4. Secure the waveguide using the screws removed in Step 2.
5. Reattach the grille using the screws removed in Step 1.

Figure 8. Removing the waveguide for rotation

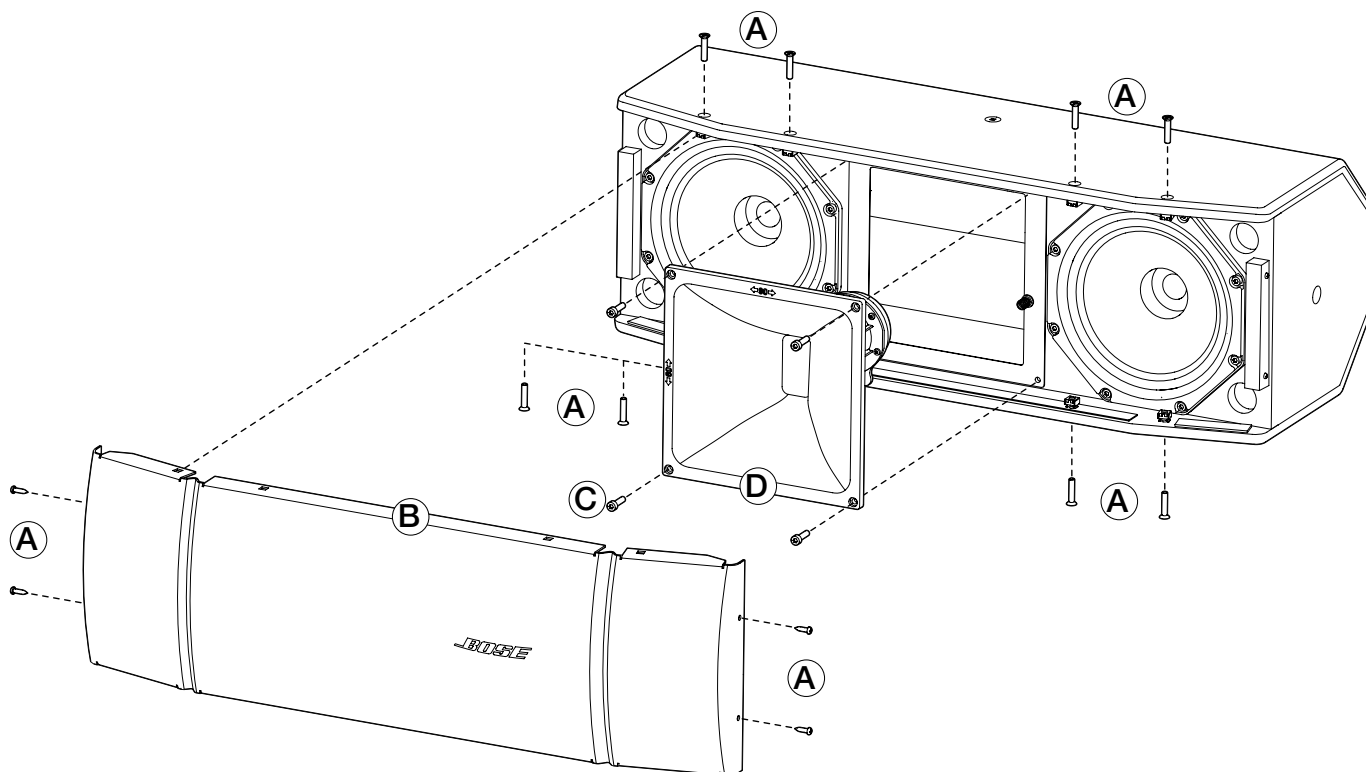

## RMUXF40/RMUXF100 70V/100V Transformer Kit Accessory

The 70V/100V transformer kit is available in 40-watt and 100-watt versions. Both versions fit all RoomMatch Utility models, after removing the standard connector panel.

	Model	Description	Product Codes
	RMUXF40W	40W 70V/100V Transformer Kit	720562-0010
	RMUXF100	100W 70V/100V Transformer Kit	720367-0010

### Removing the standard connector panel

1. Remove the four screws on the rear connector panel (Figure 10).

Figure 9. Removing rear connector panel

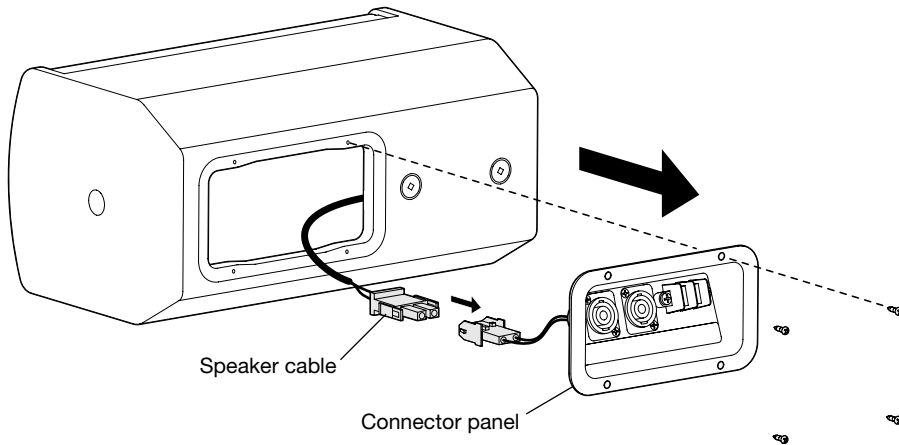

2. Gently remove the connector panel from the speaker cabinet.

**Note:** The connector panel has a gasket that may cause some resistance when attempting to remove the connector panel. It may be necessary to lift one edge away from the speaker cabinet using a small blade screwdriver or another similar tool.

3. Disconnect the speaker cable from the connector panel.

### Installing the transformer kit

1. Connect the transformer kit cable to the speaker cable (Figure 11).

Figure 10. Installing transformer kit on speaker cabinet

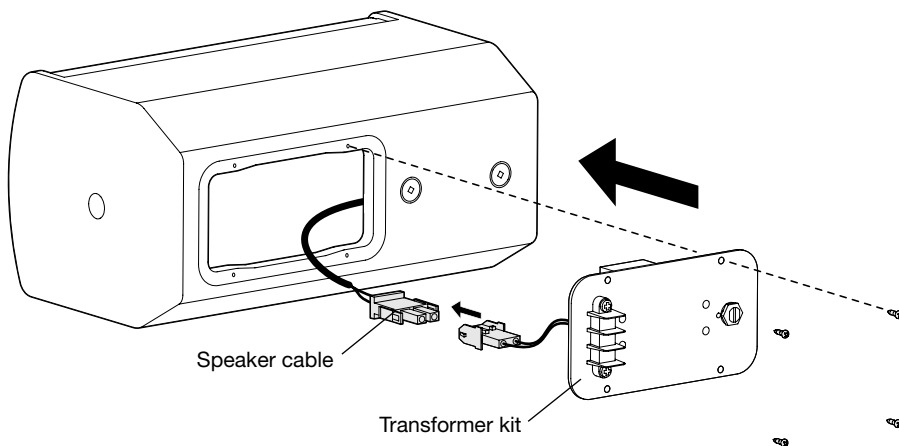

2. Place the transformer kit on the speaker cabinet and secure it with four screws.



## RMUBRKT1 RMU Pan-and-Tilt Bracket Accessory

The RMUBRKT1 pan-and-tilt wall bracket (Figure 12) allows both pitch and yaw adjustment and is available from Bose. The bracket fits the threaded inserts on the rear panel of loudspeakers.

**CAUTION:** Two lengths of M8 pan head screws are included. Use only the M8 x 20mm screws for attaching the bracket to RMU speakers. The M8 x 45mm screws are for use with non-RMU loudspeakers.

Figure 11. Pan and tilt bracket and speaker insert spacing

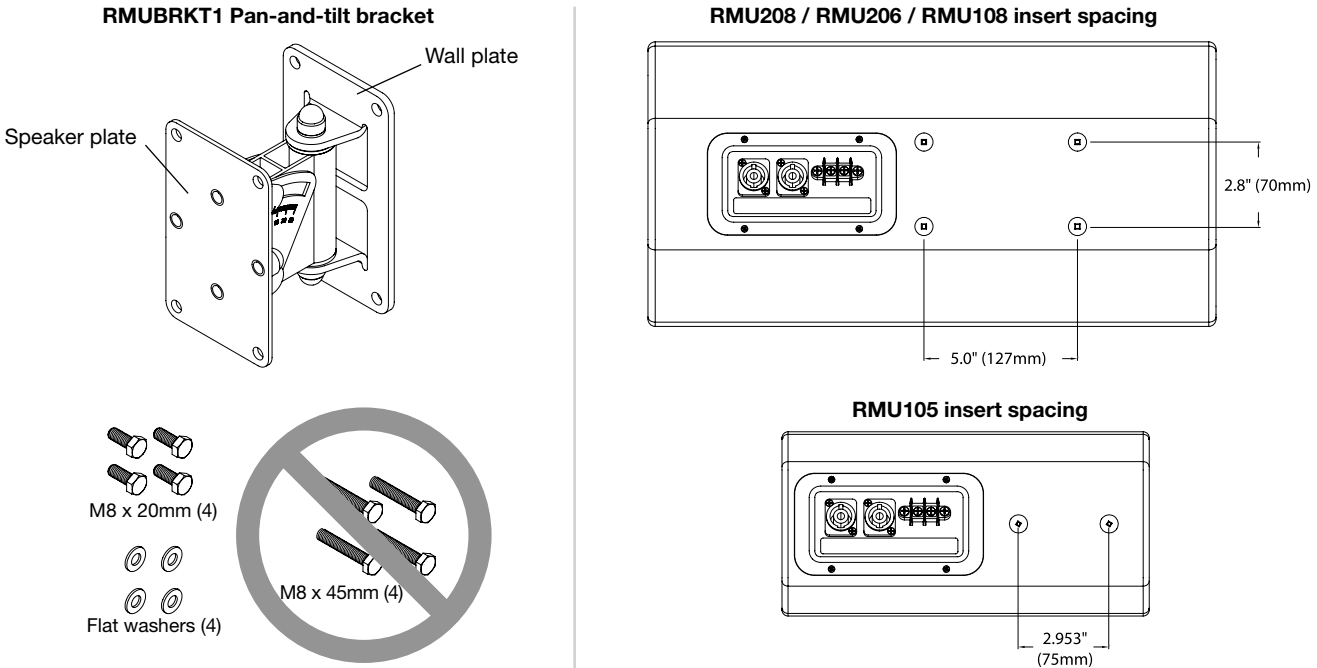

### To mount the RMU loudspeakers using the bracket:

1. Remove the lower carriage bolt and separate the front and rear halves of the bracket.

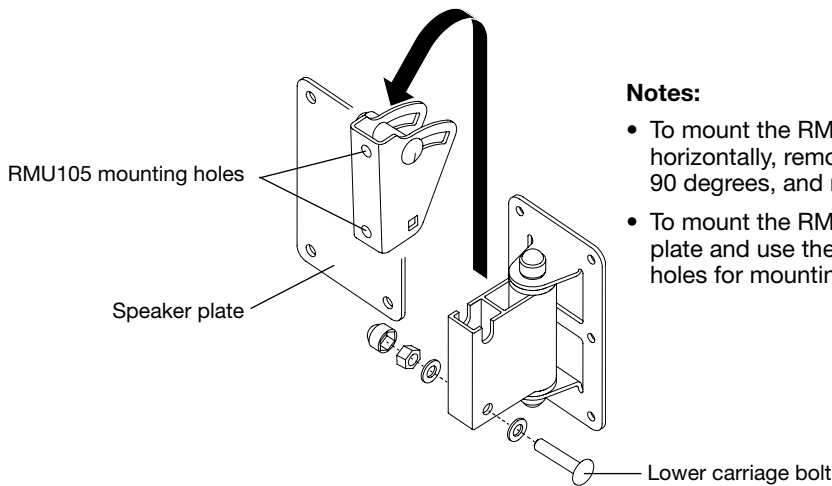

#### Notes:

- To mount the RMU208, RMU206, or RMU108 horizontally, remove the speaker plate, rotate it 90 degrees, and reattach it.
- To mount the RMU105, remove the speaker plate and use the two speaker plate mounting holes for mounting the RMU105.

2. Attach the bracket to the wall. Follow the instructions provided with the wall bracket.

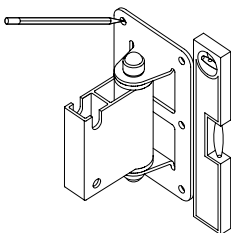

**CAUTION:** Choose a position and mounting method consistent with local building codes and regulations. Ensure the mounting surface and the method of attaching the loudspeaker to the surface is structurally capable of supporting the weight of the loudspeaker. A 10:1 safety weight ratio is recommended.

- Using the included T3 square drive, remove the plastic inserts on the rear panel of the loudspeaker and attach the bracket to speaker using **only** the included M8 x 20mm screws.

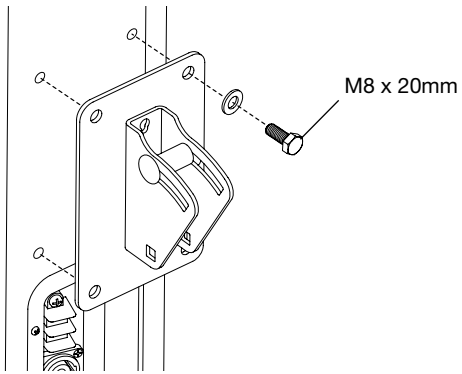

- Hang the speaker on the wall-mounted half of the bracket and install the lower carriage bolt removed earlier.

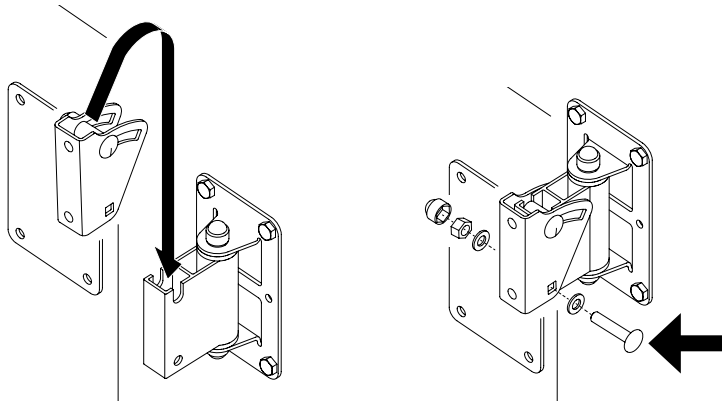

- Adjust the pitch and yaw using the specified tightening torque.

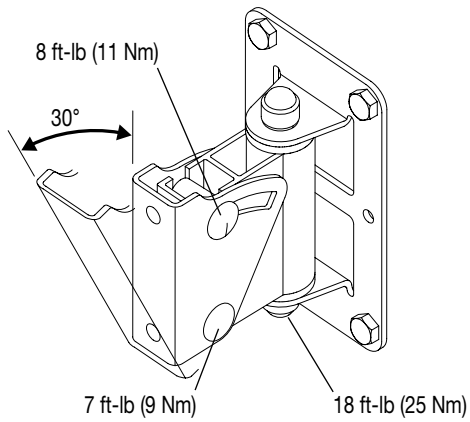

## Mounting the RMU108 Loudspeaker on a Speaker Stand

The RMU108 is the only RMU loudspeaker that has two M8 threaded inserts on one end for mounting an industry-standard stand-mount adapter. This allows you to vertically mount the RMU108 on a speaker stand, such as the Bose SS10 model. Other stands have not been tested and may create a tipping hazard.

1. Using the T3 square drive (included), remove the two plastic inserts on the end panel of the RMU108 loudspeaker.

**Note:** You may need to remove the center insert to allow the adapter to fit properly.

2. Attach the bracket to the loudspeaker using M8 screws.
3. Mount the loudspeaker on the stand and tighten the bracket.



Figure 12. RMU108 speaker stand adapter threaded inserts

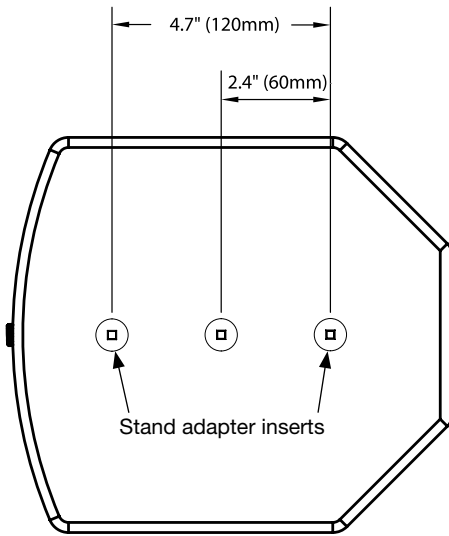

## Recommended Amplifier

Selecting the proper amplifier size for a given loudspeaker requires analysis of the transducer long-term (or RMS) power rating, dynamic range of the input-source material (crest factor), desired sound pressure levels, and other factors. As a general guideline, the following table provides recommended power amplifier ranges for each RoomMatch® Utility model:

RoomMatch Utility Model	Nominal Impedance	Required Channels	Amp Power Rating
RMU208	8 ohms	1	300 – 1200 W
RMU206	8 ohms	1	250 – 1000 W
RMU108	8 ohms	1	200 – 800 W
RMU105	8 ohms	1	100 – 400 W

**CAUTION:** Failure to follow these guidelines may result in damage to the loudspeaker.

The Bose® PowerMatch® configurable power amplifiers offer optimal amplification and DSP for RoomMatch Utility loudspeakers. Please refer to the specifications listed on the [pro.bose.com](http://pro.bose.com) website for PowerMatch amplifiers and compare with the table above to determine which PowerMatch model is best for your particular RoomMatch Utility system design.

## Recommended Signal Processing

Digital signal processing (DSP) equipment is required for infrasonic protection and amplifier power limiting functions. This processing is available in optional products from Bose such as the PowerMatch® amplifiers and/or ControlSpace® DSP hardware.

The following table lists the recommended infrasonic bandpass protection and amplifier limiter settings for each RoomMatch® Utility loudspeaker when used without optional subwoofers:

Speaker	Bandpass				Limiter					
	High Pass		Low Pass		V Peak			V RMS		
	Type	Freq.	Type	Freq.	Threshold	Attack	Release	Threshold	Attack	Release
RMU208	BW24	70	BW24	20000	98.0	1.5	100.00	49.0	1000.00	2000.00
RMU206	BW24	80	BW24	20000	89.0	1.5	100.00	44.5	1000.00	2000.00
RMU108	BW24	80	BW24	20000	80.0	1.5	100.00	40.0	1000.00	2000.00
RMU105	BW24	90	BW24	20000	56.5	1.5	100.00	28.0	1000.00	2000.00

## Technical Specifications

	RMU208	RMU206	RMU108	RMU105
<b>System Performance</b>				
Frequency Response (±3 dB) <sup>(1)</sup>	80 – 16 kHz	90 – 16 kHz	90 – 16 kHz	100 – 16 kHz
Frequency Range (-10 dB)	70 – 16 kHz	80 – 16 kHz	80 – 16 kHz	90 – 16 kHz
Coverage Pattern, Horizontal	90° (rotatable)	120° (rotatable)	90° (rotatable)	100° (rotatable)
Coverage Pattern, Vertical	60° (rotatable)	60° (rotatable)	60° (rotatable)	100° (rotatable)
Long-Term Power Handling, Bose <sup>(2)</sup>	300 W	250 W	200 W	100 W
Long-Term Power Handling, AES <sup>(3)</sup>	400 W	300 W	250 W	150 W
Calculated Maximum SPL@1 m, peak <sup>(4)</sup>	128 dB	123 dB	123 dB	118 dB
<b>Transducers</b>				
Low Frequency	2 x Bose 8-inch woofer	2 x Bose 6.5-inch woofer	1 x Bose 8-inch woofer	1 x Bose 5.25-inch woofer
High Frequency	1 x Bose EMB2 compression driver			
Nominal Impedance	8 ohms (70V / 100V optional)			
<b>Physical</b>				
Dimensions (H x W x D), inches	9.3" x 27.0" x 10.5"	7.0" x 19.0" x 9.0"	9.3" x 18.5" x 10.5"	6.0" x 12.0" x 7.5"
Dimensions (H x W x D), mm	236 x 686 x 267 mm	178 x 483 x 229 mm	236 x 470 x 267 mm	152 x 305 x 191 mm
Net Weight	37 lb (16.8 kg)	25 lb (11.3 kg)	21 lb (9.5 kg)	12 lb (5.4 kg)
Net Weight with U-Bracket	43 lb (19.5 kg)	30 lb (13.6 kg)	26 lb (11.8 kg)	15 lb (6.8 kg)
Finish Color	black or white			
Environmental Rating	Indoor			

- Notes:**
1. Frequency response and range measured on-axis, in an anechoic environment.
  2. Long-Term Power Handling, Bose Extended-Lifecycle Test.
  3. Long-Term Power handling, AES Transducer Test.
  4. Maximum SPL calculated from acoustic half-space sensitivity and AES power handling specifications, exclusive of power compression.

Visit us on the web at [pro.Bose.com](http://pro.Bose.com).

### Americas

(USA, Canada, Mexico, Central America, South America)  
Bose Corporation  
The Mountain  
Framingham, MA 01701 USA  
Corporate Center: 508-879-7330  
Americas Professional Systems,  
Technical Support: 800-994-2673

### Australia

Bose Pty Limited  
Unit 3/2 Holker Street  
Newington NSW Australia  
TEL 61 2 8737 9999

### Belgium

Bose N.V. / S.A  
Limesweg 2, 03700  
Tongeren, Belgium  
TEL (32) 012-390800

### China

Bose Electronics (Shanghai) Co Ltd  
25F, L'Avenue  
99 Xianxia Road  
Shanghai, P.R.C. 200051 China  
86 21 6010 3800

### France

Bose S.A.S  
12 rue de Temara  
78100 St. Germain en Laye, France  
TEL 01-30-61-63-63

### Germany

Bose GmbH  
Max-Planck Strasse 36D 61381  
Friedrichsdorf, Deutschland  
TEL 06172-7104-0

### Hong Kong

Bose Limited  
Suites 2101-2105, Tower One, Times Square  
1 Matheson Street, Causeway Bay, Hong Kong  
TEL 852 2123 9000

### India

Bose Corporation India Private Limited  
Salcon Aurum, 3rd Floor  
Plot No. 4, Jasola District Centre  
New Delhi – 110025, India  
TEL 91 11 43080200

### Italy

Bose SpA  
Centro Leoni A – Via G. Spadolini  
5 20122 Milano, Italy  
TEL 39-02-36704500

### Japan

Bose Kabushiki Kaisha  
Sumitomo Fudosan Shibuya Garden Tower 5F  
16-17, Nanpeidai-cho  
Shibuya-Ku, Tokyo, 150-0036, Japan  
TEL 81-3-5489-0955  
[www.bose.co.jp](http://www.bose.co.jp)

### The Netherlands

Bose BV  
Nijverheidstraat 8 1135 GE  
Edam, Nederland  
TEL 31 (0)299-390139

### United Kingdom

Bose Ltd  
1 Ambley Green, Gillingham Business Park  
KENT ME8 0NJ  
Gillingham, England  
0870-741-4500

**See website for other countries**

## Importer Information

### European Union

Bose GP, Castleblayney Road, Carrickmacross, County Monaghan, Ireland

### China

Bose Electronics (Shanghai) Company Limited, Part C, Plan 9, No. 353 North Riyang Road, China (Shanghai) Pilot Free Trade Zone

### Taiwan

Bose Taiwan Branch, 9F-A1, No. 10, Section 3, Minsheng East Road, Taipei City 104, Taiwan  
Tel: 886 2 2514 7977

### Mexico

Bose de México, S. de R.L. de C.V., Paseo de las Palmas 405-204, Lomas de Chapultepec, 11000 México, D.F.  
Tel: 001 800 900 2673

## Limited Warranty

Your product is covered by a limited warranty, Visit [pro.Bose.com](http://pro.Bose.com) for warranty details.

The warranty information provided with this product does not apply in Australian and New Zealand. See our website at [www.bose.com/au/warranty](http://www.bose.com/au/warranty) or [www.bose.com/nz/warranty](http://www.bose.com/nz/warranty) for details of the Australian and New Zealand warranty.



738637-0010

©2016 Bose Corporation. All rights reserved.  
The Mountain, Framingham, MA 01701-9168 USA  
[www.pro.Bose.com](http://www.pro.Bose.com)  
All trademarks are the property of their respective owners.  
AM738637 Rev. 02

