

### EW-D Smart Assist



### Sennheiser Documentation App



or online at  
[www.sennheiser.com/download](http://www.sennheiser.com/download)



## Evolution Wireless Digital Portable

EW-DP EK, EW-D SK, EW-DP SKP, EW-D SKM-S

Quick Guide

Kurzanleitung

Guide rapide

Guía rápida

Guía de inicio rápido

Guia rápido

Beknopte handleiding

Krótki instrukcja obsługi

Snabbguide

Kort vejledning

Pikaohje

Γρήγορος οδηγός

Kısa Kılavuz

Краткая инструкция

简要说明

快速使用指南

クイックガイド

요약 안내서

Sennheiser electronic GmbH & Co. KG

Am Labor 1, 30900 Wedemark, Germany  
[www.sennheiser.com](http://www.sennheiser.com)

Printed in Germany  
 Publ. 08/23, 592859/A04

**SENNHEISER**

### EW-DP EK

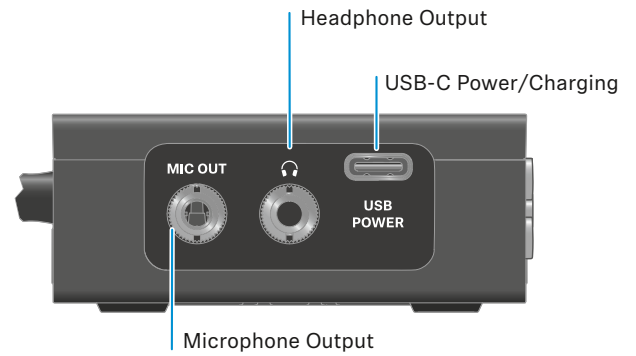
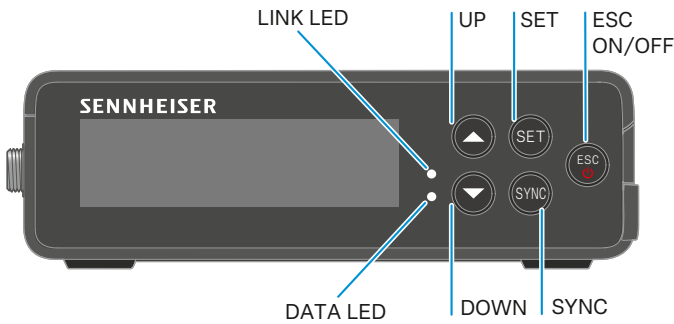

### EW-DP SKP

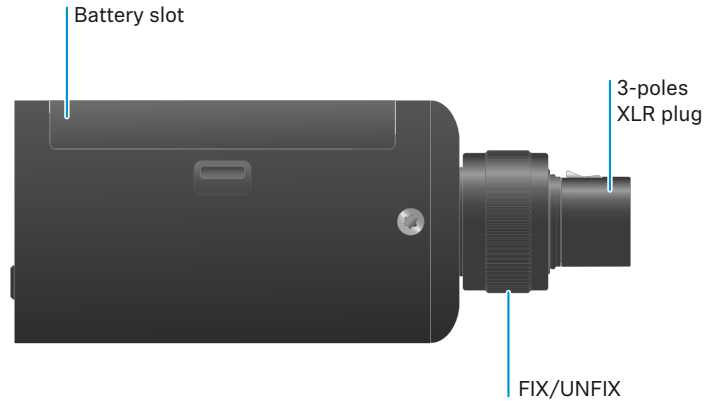
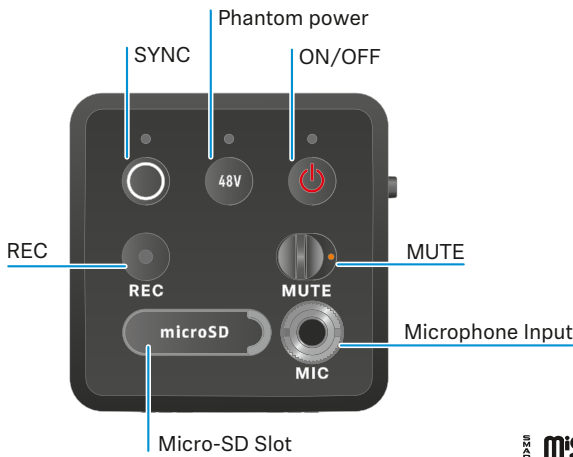

### EW-D SKM-S

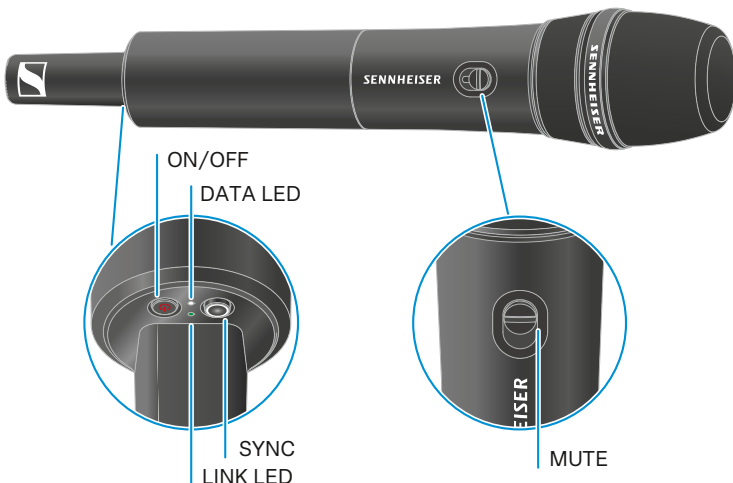

### EW-D SK

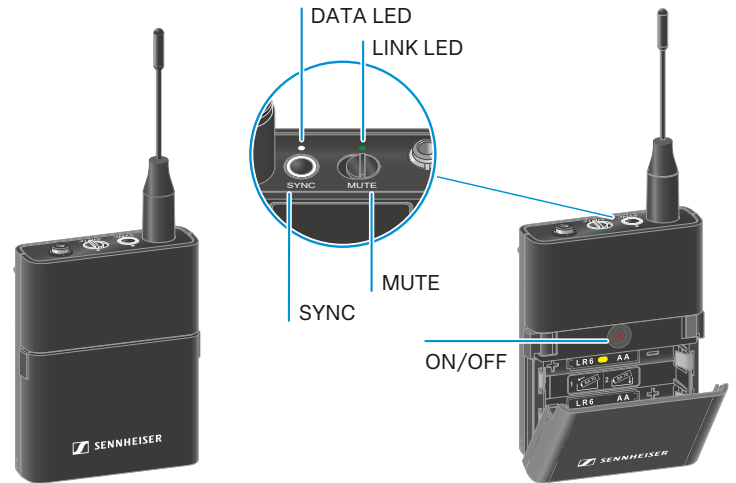

**On/Off**

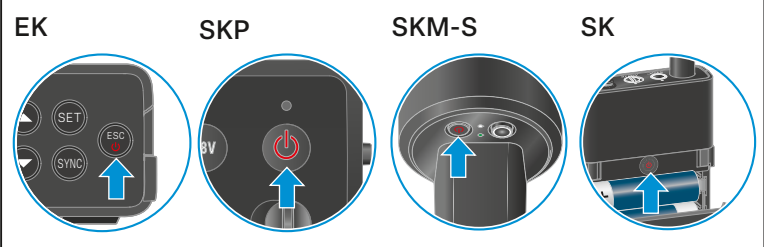

Off -> On	<b>EK/SKP/SK/SKM-S</b>	On -> Off	<b>EK/SKP/SK/SKM-S</b>
	on		off

**EK Setup**

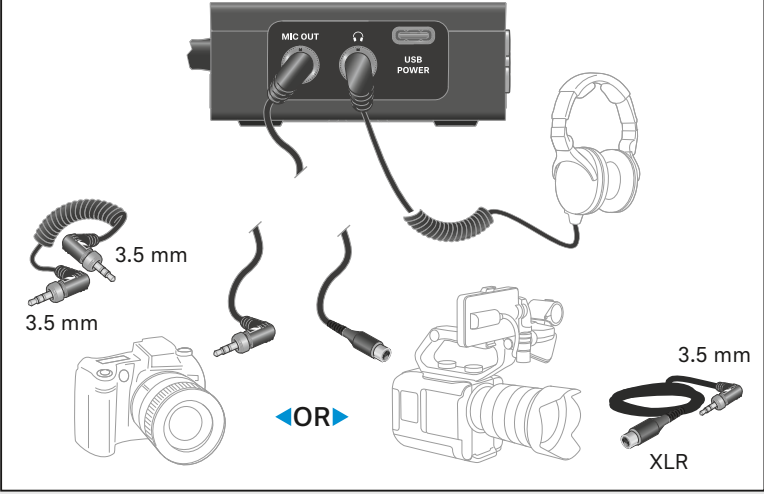

**Mute**

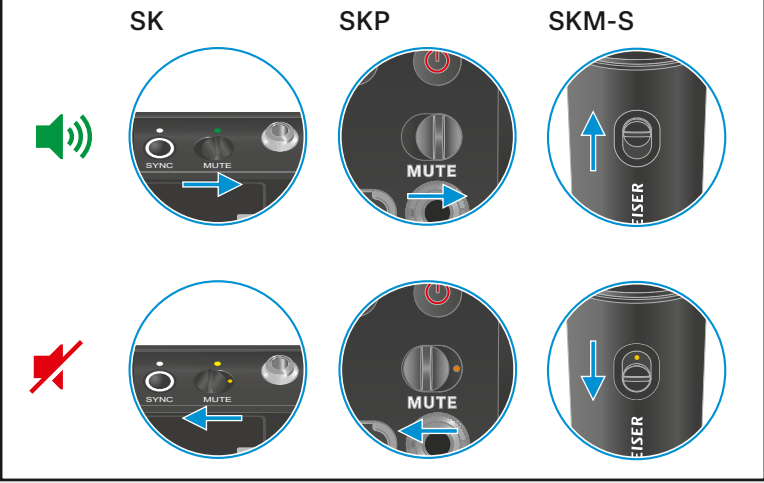

**EK Power Supply / Charging**

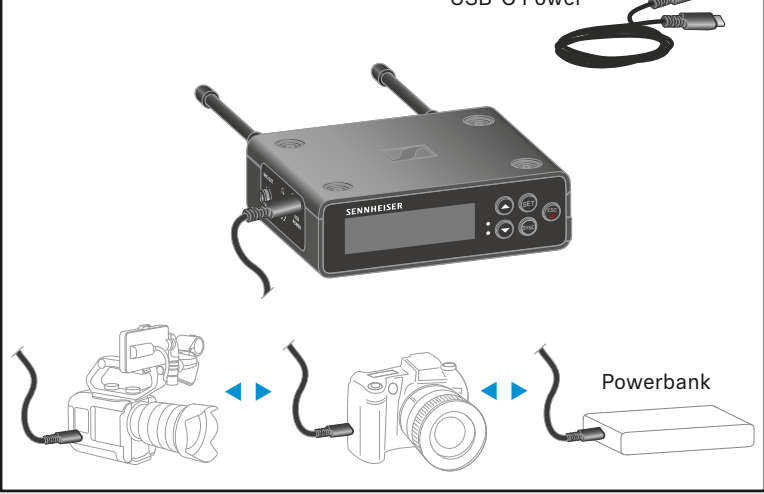

**Battery**

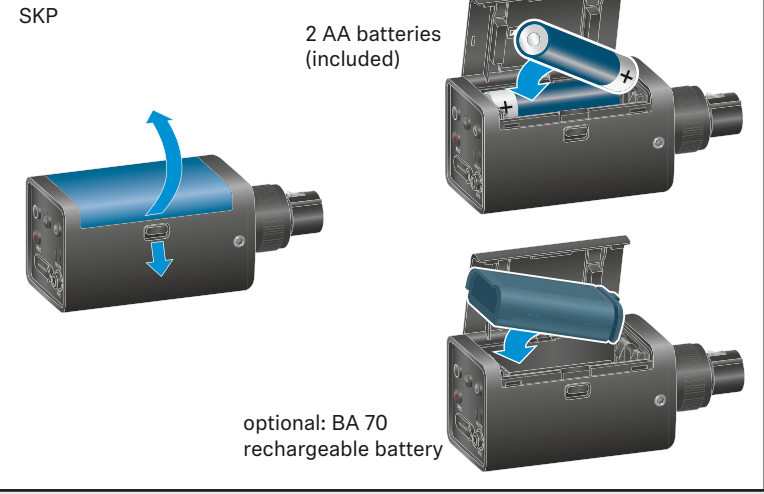
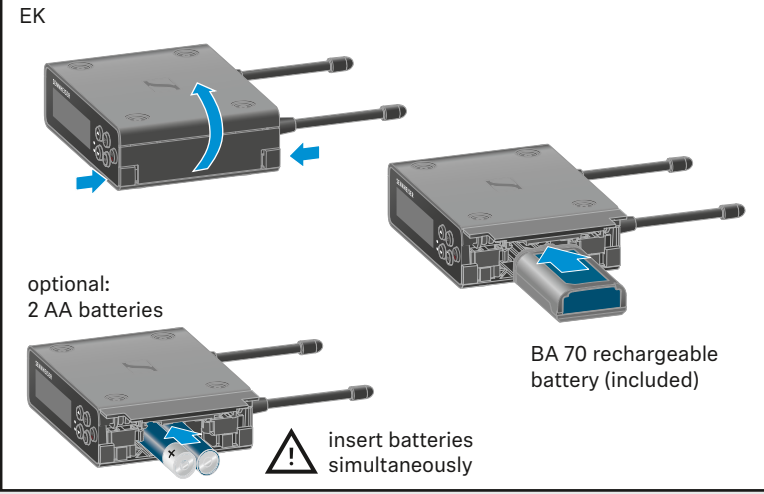

**Battery**

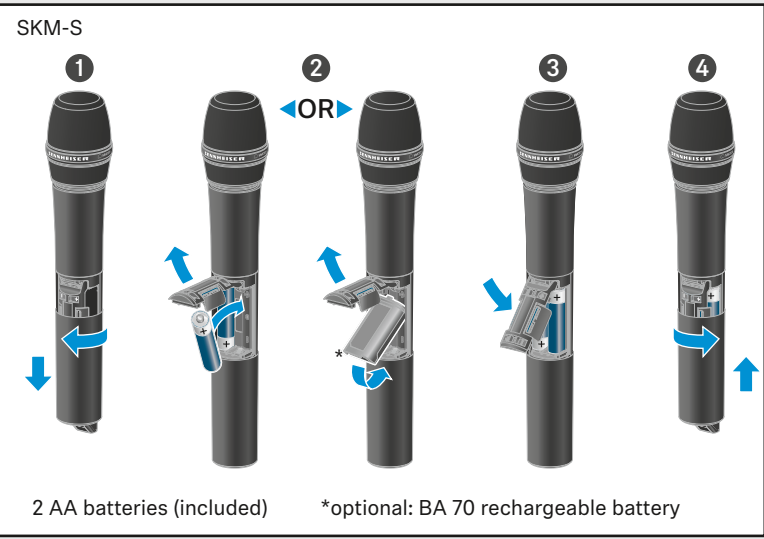
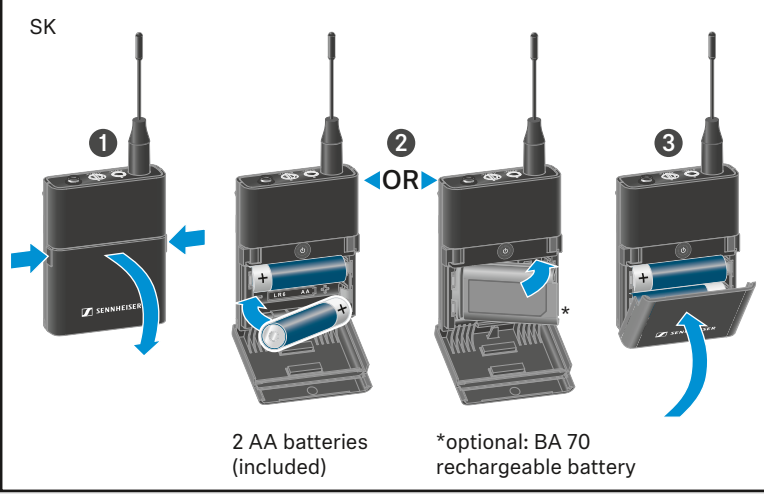

## LEDs

LINK LED/ PWR LED (SKP)	
	- Link ok - audio active
	- Link ok - audio muted or no capsule on SKM
	- Link ok - audio clip
	- No link
	- Link ok - Low transmitter battery
	- Device switched off

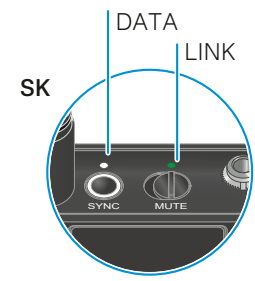
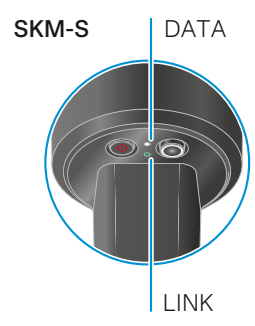
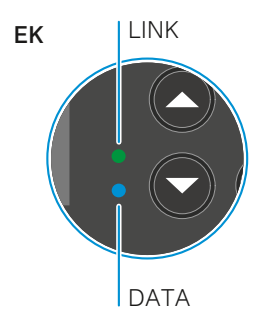

DATA LED	
	Bluetooth active to - sync with transmitter - connect with app
	Firmware update in progress

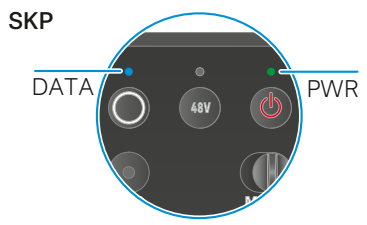

## Identify/Battery check

On -> Identify/Check

**SK/SKP/SKM-S**  
short Identify/Check

LINK LED SK/SKP/SKM-S	
	≤ 100 %
	≤ 60 %
	≤ 20 %

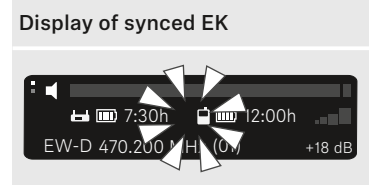
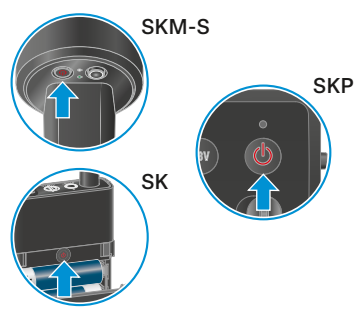

## Sync

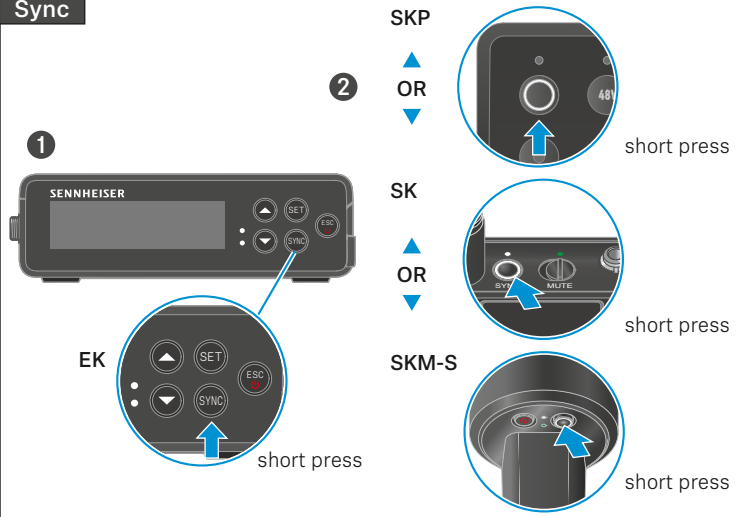

## EK Stacking/ Mounting plate

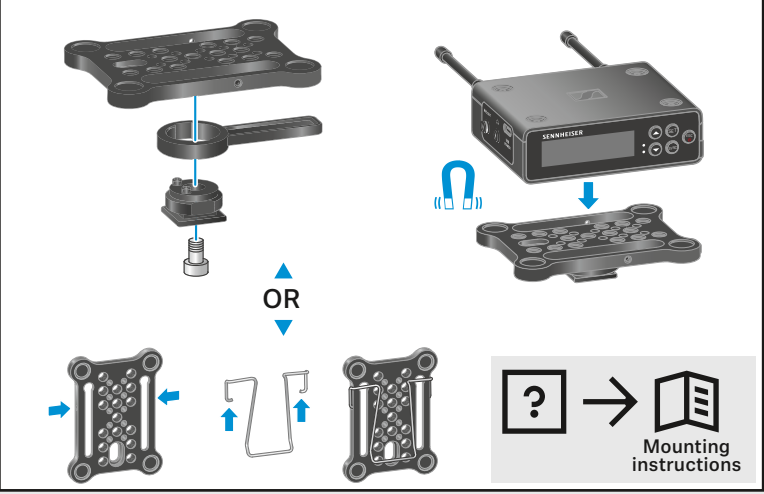

## SKP Attach & Record

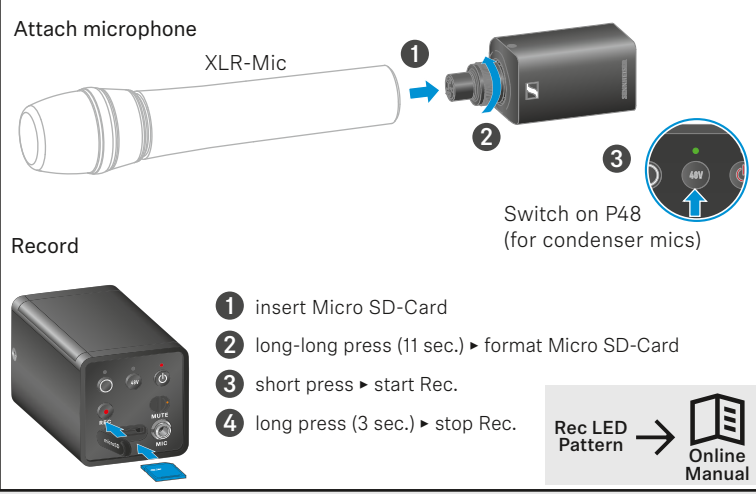

## Mic Handling

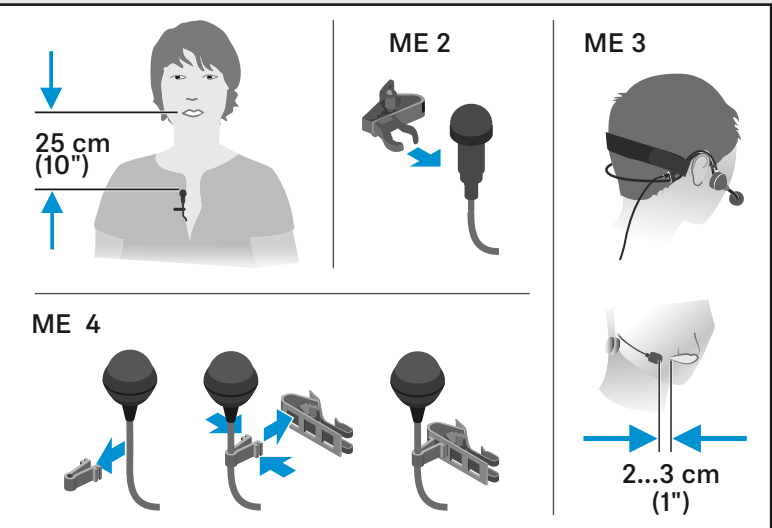

# EK Display

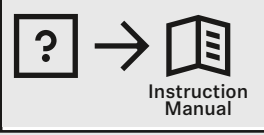
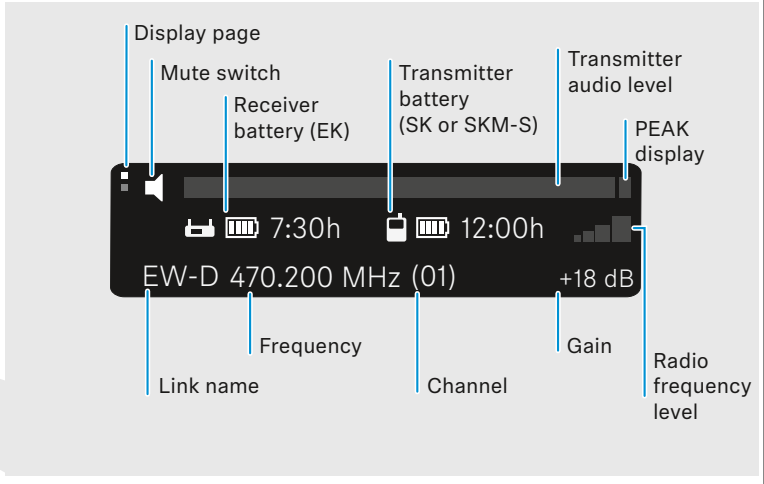
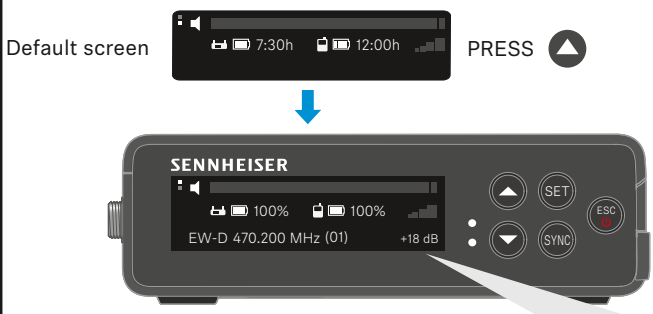

# EK Menu

	→ SET →	<b>Gain</b> Output level SET ↓	→ SET →	Gain +21 dB +24 +18 SET ↑ ↓
	→ SET →	<b>Output level</b> Headphone SET ↑ ↓	→ SET →	Output level -15 dB 0 dB -20 dB SET ↑ ↓
	→ SET →	<b>Headphone</b> Mute switch SET ↑ ↓	→ SET →	Headphone Bar graph SET ↑ ↓
	→ SET →	<b>Mute switch</b> Auto scan SET ↑ ↓	→ SET →	Mute switch ignored active SET ↑ ↓
	→ SET →	<b>Auto scan</b> Channel SET ↑ ↓	→ SET →	Auto scan 526.000 MHz (94) SET ↑ ↓
	→ SET →	<b>Channel</b> Frequency SET ↑ ↓	→ SET →	Channel 94 526.000 MHz 93 1 SET ↑ ↓
	→ SET →	<b>Frequency</b> Brightness SET ↑ ↓	→ SET →	Frequency 470 .200 MHz 471 526 SET ↑ ↓
	→ SET →	<b>Brightness</b> Reset SET ↑ ↓	→ SET →	Brightness 60 % 80 40 SET ↑ ↓
	→ SET →	<b>Reset</b> Brightness SET ↑ ↓	→ SET →	Reset to factory defaults? Yes SET No ESC SET ↑ ↓

Instruction manual | Bedienungsanleitung |  
 Notice d'emploi | Istruzioni per l'uso |  
 Instrucciones de manejo | Manual de  
 instruções | Gebruiksaanwijzing |  
 Instrukcja obsługi | Bruksanvisning |  
 Betjenings vejledning | Käyttöohje |  
 Οδηγίες λειτουργίας | Kullanım kılavuzu |  
 Инструкция по эксплуатации | 使用说明书 |  
 使用説明書 | 取扱説明書 | 사용 설명서

## EW-D Smart Assist



## Sennheiser Documentation App

